

# 무소음 캐스터

(Low Noise Caster 경하중)



MR 2640 ELA-R    MR 2640 ELA-BK    MR 2640 ELA-S

## 제원(Dimension)

※ 주문제작 가능

S(회전-Swivel)  
R(고정-Rigid)  
B/K(브레이크-Brake)  
BT(볼트-Bolt)  
BT B/K(볼트브레이크-Bolt Brake)

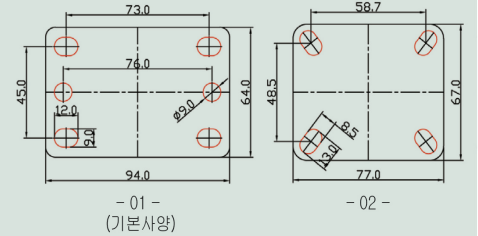

## 제품 특징

- 무소음 그리스 사용 (No noise grease used)
- 학교, 도서관 (School, Library)
- 병원용 기기 (Hospital Equipment)
- 연구소 (Laboratory)

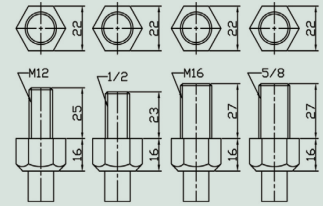

## DS 26 SERIES - 경량용 사양(Specification)

제품명 (MODEL)	Wheel Dia(mm)	Tread Width(mm)	Wheel Material	Bearing	Load Height(mm)	Load Height(mm)	Swivel Radius		Load Capacity(kg)	박스당수량 PCS
							S	B/K		
MR 2630 ELA	76	25	Elastomer	608ZZ	113	119	68	97	60	32
MR 2630 EPU	76		Elastic Poly Urethane		113	119	68	97	70	32
MR 2640 ELA	101		Elastomer		138	144	81	97	70	24
MR 2640 EPU	101		Elastic Poly Urethane		138	144	81	97	80	24
MR 2650 ELA	127		Elastomer		163	169	97	97	80	20

# 무소음 캐스터

(Low Noise Caster 중하중)



DS 2651 ELA-BK    DS 2651 ELA-S    DS 2651 ELA-R

## 제원(Dimension)

S(회전-Swivel)  
R(고정-Rigid)  
B/K(브레이크-Brake)

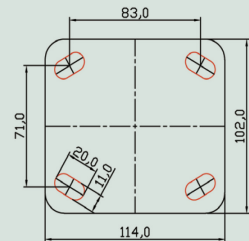

## 사양(Specification)

제품명 (MODEL)	Wheel Dia(mm)	Tread Width(mm)	Wheel Material	Bearing	Load Height(mm)	Swivel Radius(mm)	Load Capacity(kg)	박스당수량 PCS
MR 2641 ELA	101	50	Elastomer	6003ZZ	141	74	150	16
MR 2651 ELA	124				163	92	200	10
MR 2661 ELA	152				190	109	250	10